



by PACIFIC ARCHITECTURAL MILLWORK

# Tilt-Turn French Casement WA8400

(rev. 02.06.18)

# Tilt-Turn French Casement WA8400

## Section Contents

Section Contents .....	1
Product Overview .....	2
Introduction .....	2
Wood Species .....	2
Glazing Options .....	2
Other Options .....	2
Product Parameters .....	3
Hardware Images .....	3
Exterior Elevation .....	4
Head Detail .....	5
Sill Detail .....	6
Left Jamb Detail .....	7
Meeting Detail .....	8
Right Jamb Detail .....	9

# Product Overview

## Introduction

We are proud to add the flexible and stylish Tilt-Turn WA8400 (Wood-Aluminum) to our product line. Popularized in Europe, the Tilt-Turn WA8400 opens to the interior like a casement window when the handle is rotated 90 degrees, or tilts in slightly when the handle is rotated 180 degrees. The tilt position allows for gentle circulation during inclement weather, while the swing position allows for convenient cleaning and maximum airflow. Multiple lock points provide added stability and security, and the durable hardware allows for oversized applications. Our Tilt-Turn WA8400 can be customized with screens, glazing options, and various hardware finishes.



## Wood Species

Our standard wood species are the following:



The mark of  
responsible forestry

- Pine
- Vertical Grain Douglas Fir
- African Mahogany

Alternative and exotic wood species are also available. See the Wood Species page in the General Info section.

## Other Options

The Tilt-Turn WA8400 can be purchased with additional options such as custom grille patterns, fixed exterior screen and brick or stucco exterior moulding.

Contact Reveal Windows & Doors for additional options and customization.

## Glazing Options

Standard glazing for the Tilt-Turn WA8400 is 1" overall insulated glass.

Custom glazing and tinted glass are available.

# Tilt-Turn French Casement WA8400

(rev. 02.06.18)

## Product Parameters

<b>Min Frame Height</b>	23-1/2" (Based on width)
<b>Max Frame Height</b>	98"
<b>Min Frame Width</b>	43"
<b>Max Frame Width</b>	92"
<b>Min Stile Width</b>	3"
<b>Min Jamb Depth</b>	3-1/4"
<b>Edge Detail</b>	<ul style="list-style-type: none"> <li>Interior/Exterior: Traditional or Contemporary edge detail</li> </ul>

## Hardware Images

	
<b>London Handle</b> (Standard)	<b>Verona Handle</b>
<ul style="list-style-type: none"> <li>Silver</li> <li>Grey Brown</li> <li>Traffic White</li> </ul>	<ul style="list-style-type: none"> <li>Polished Brass</li> <li>Antique Brass</li> <li>Brushed Chrome</li> <li>Polished Chrome</li> <li>Oil-Rubbed Brass</li> <li>Pure White</li> <li>Matte Black</li> <li>Satin Nickel</li> <li>Antique Nickel</li> </ul>

Custom hardware and handles are also available.

# Exterior Elevation

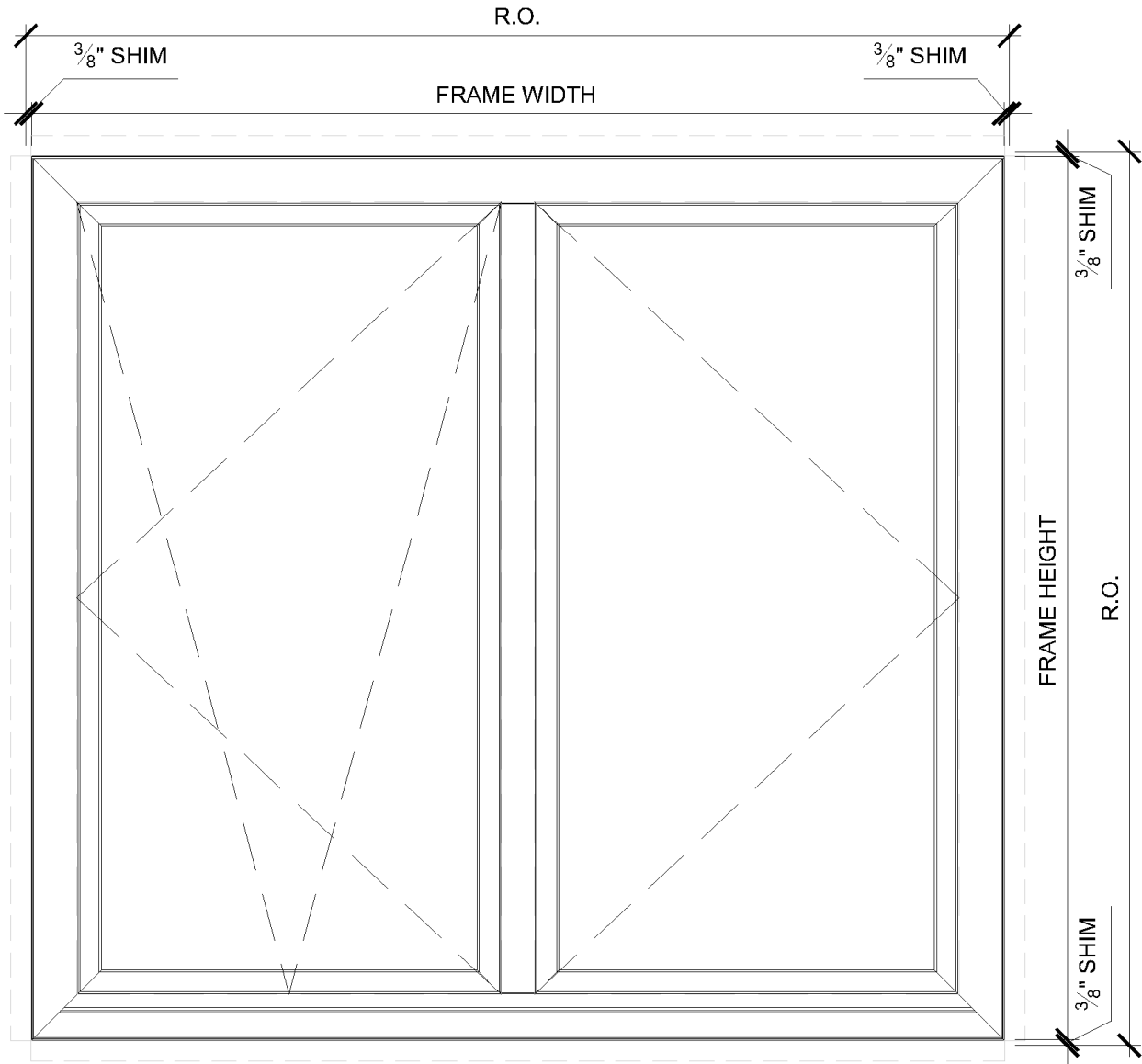

# Tilt-Turn French Casement WA8400

(rev. 02.06.18)

## Head Detail

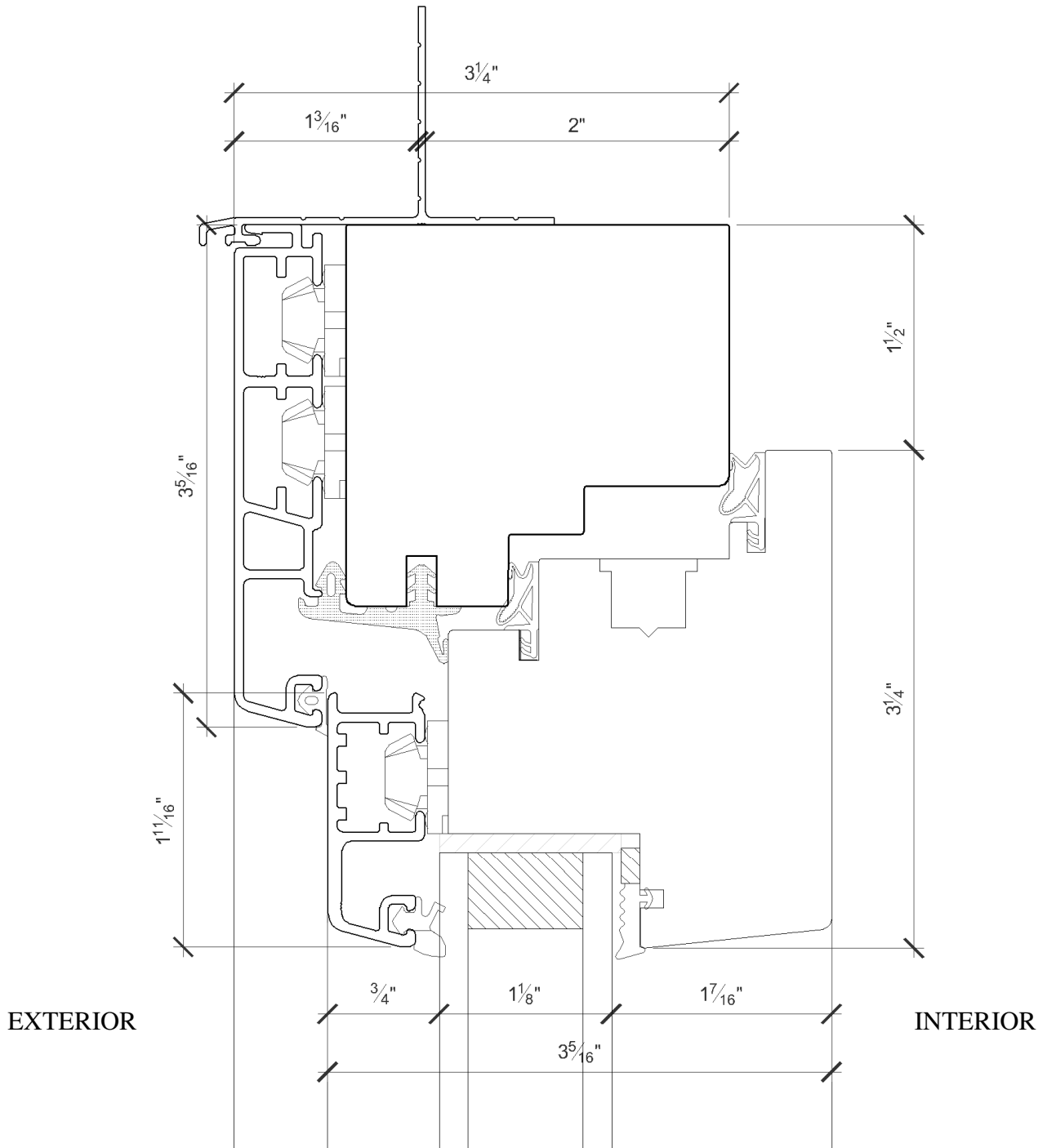

# Tilt-Turn French Casement WA8400

(rev. 02.06.18)

## Sill Detail

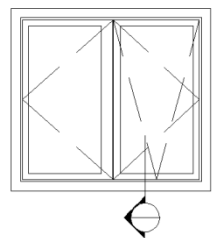
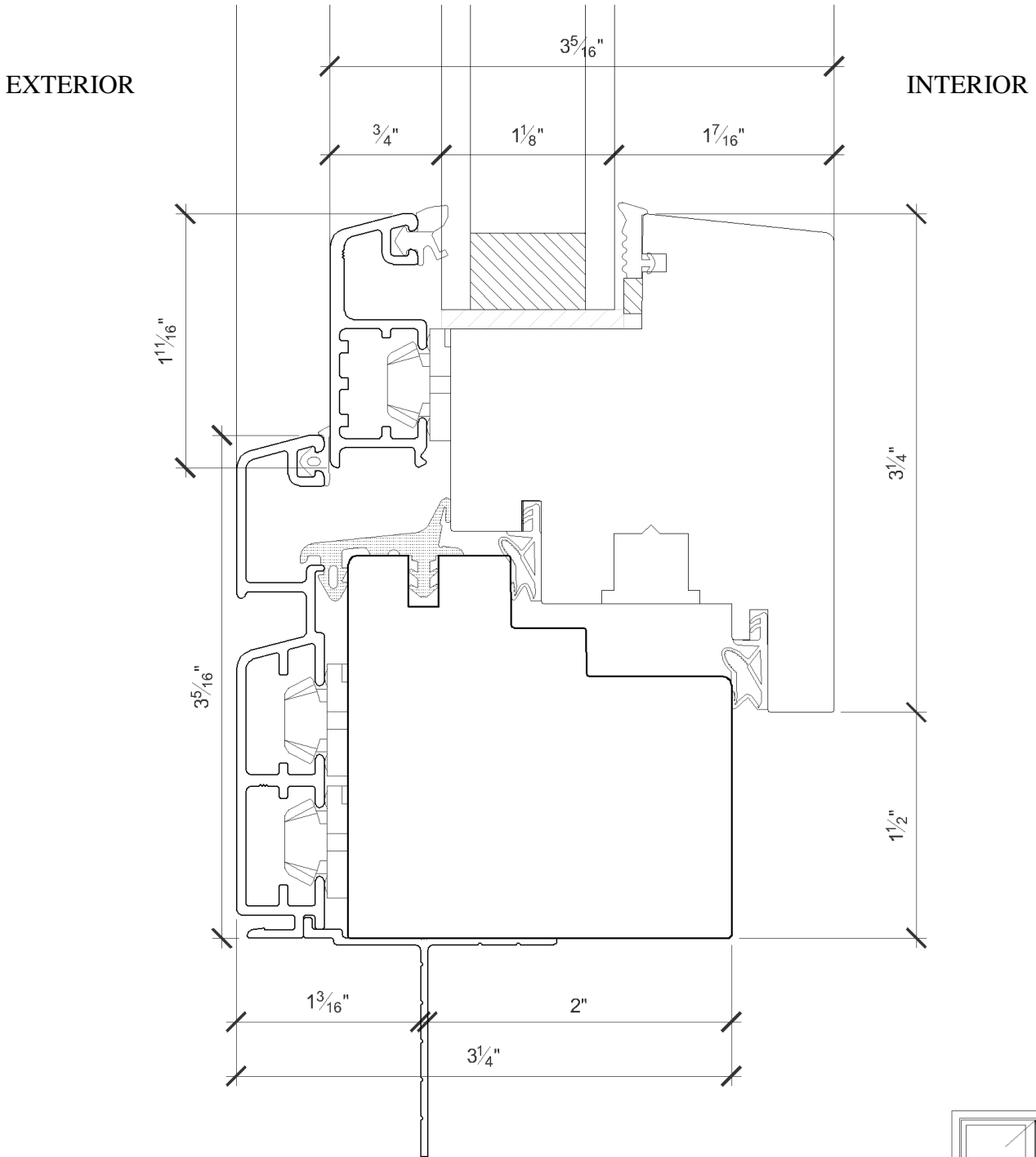

# Tilt-Turn French Casement WA8400

(rev. 02.06.18)

## Left Jamb Detail

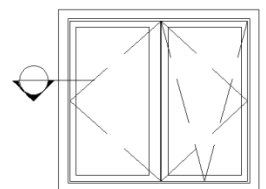
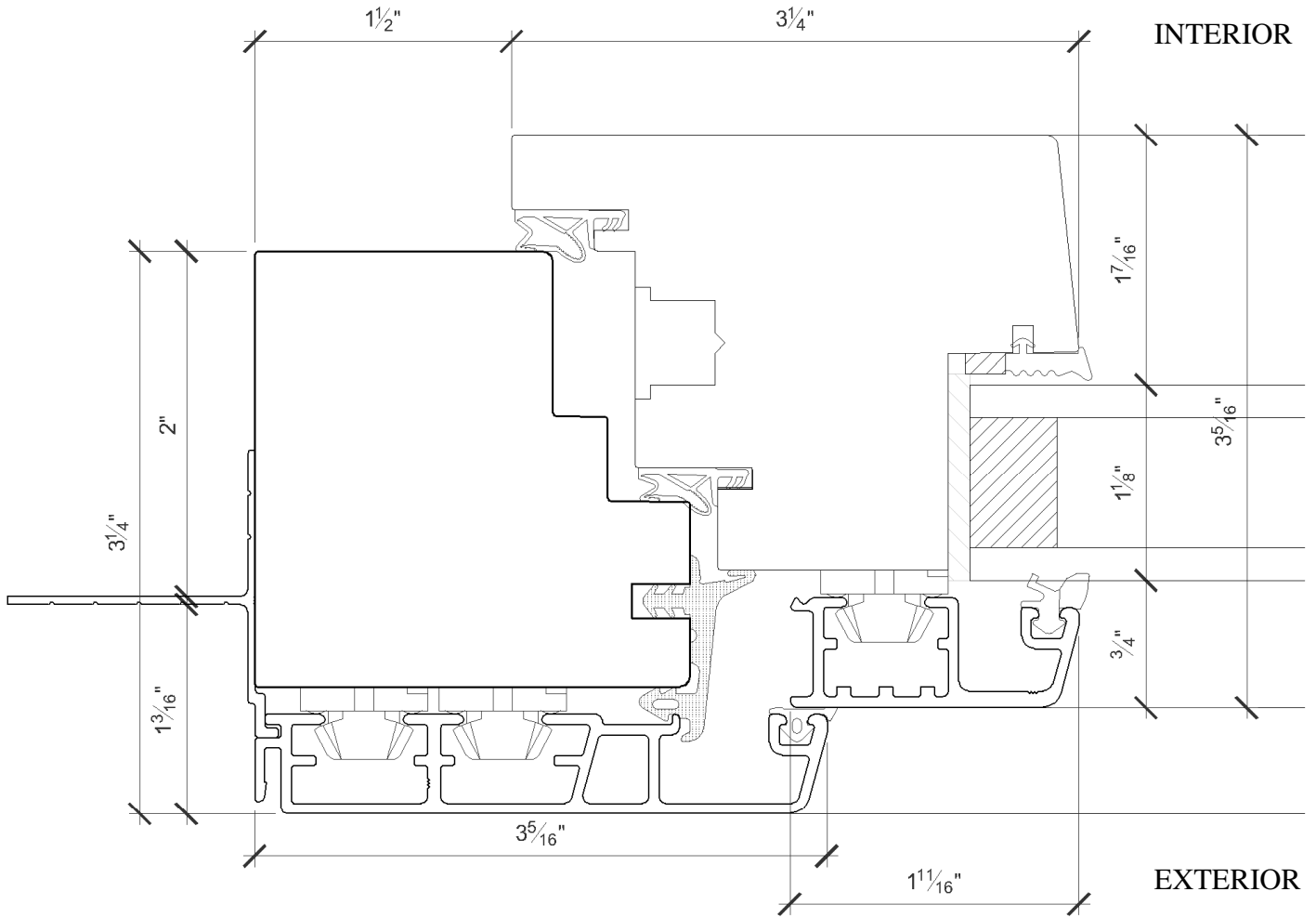



# Tilt-Turn French Casement WA8400

(rev. 02.06.18)

## Meeting Detail

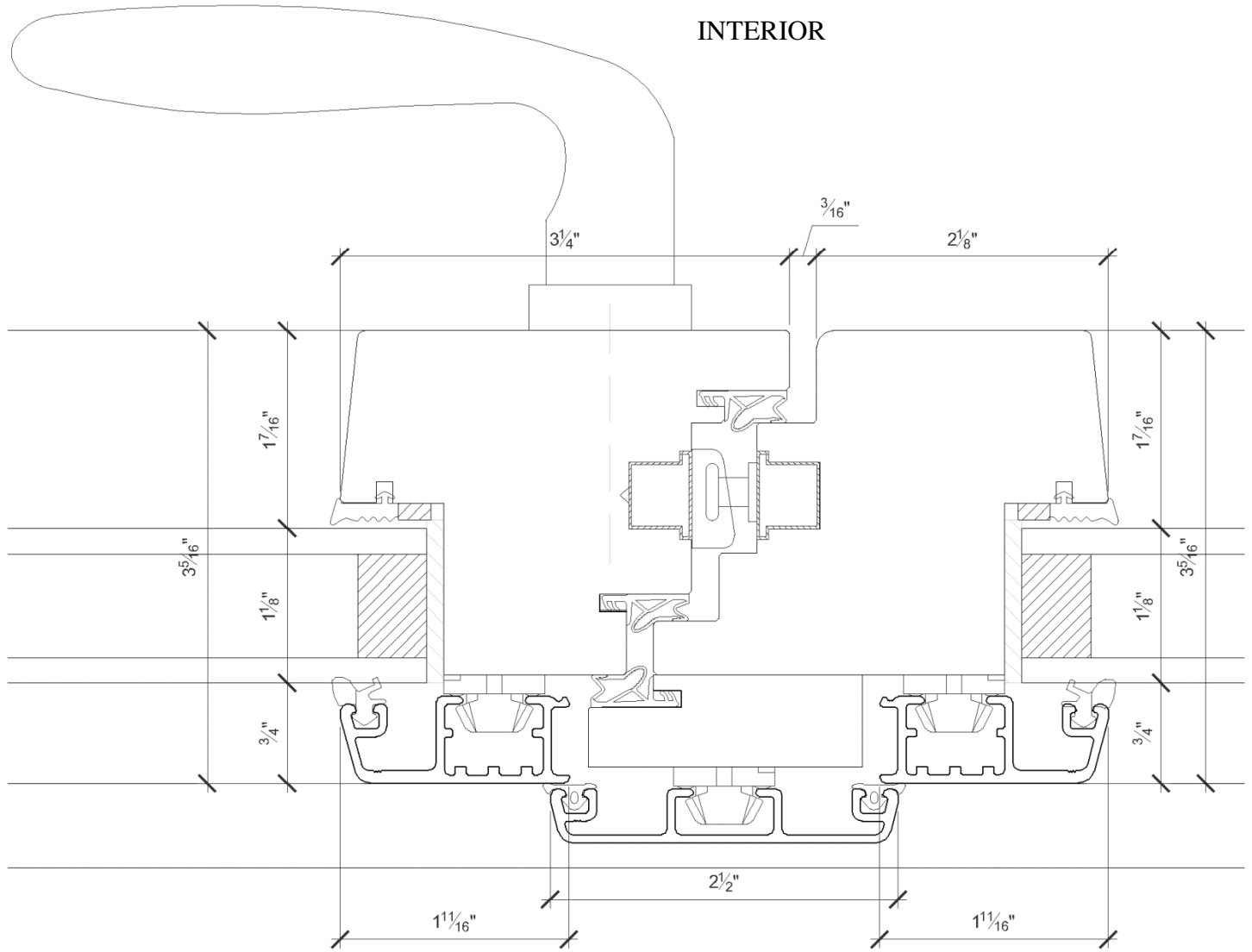

EXTERIOR

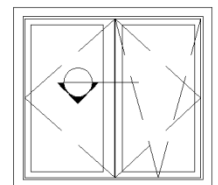

# Right Jamb Detail

